

ClipOn 9103, 9104

9103/910300

9104/910400

5 *års garanti*
years warranty
Jahre Garantie
ans de garantie

Components:

Upper tubular frame with two associated sheet steel hooks. Lower tubular frame with two adjustable tubular leg hooks. Eccentric handle for clamping in place. "Rubber cradles" with retaining straps for bikes and extra straps for securing the load.

Materials:

Powder-coated tubes of galvanized sheet steel. Hooks of pebax-treated steel.

Mounting, etc.:

Assemble the product according to enclosed mounting instructions. Very easy to use, three-step mounting.

- 1) Hook in the top hooks (see the Thule buying guide for hook-mounting holes).
- 2) Hook in the bottom hooks (adjustment by screw thread).
- 3) Clamp in place using the eccentric handle.



Accessories:

9110, 9111, 9112, 9113 (see Thule Buying Guide)
Bike Frame Adapter 982
Locking wire 538
Light board 975

- Can carry up to three bikes.
- Patented snap mounting for simple securing to the luggage compartment lid.
- Simple mounting in three steps and convenient securing by means of quick fastener.
- Very simple to refit when the holder has been finally adjusted. Just clip it into place.
- Quick release handle to easily tilt/fold product.
- Rubber frame-holder that protects the bikes.
- All parts that come into contact with the car paintwork are coated with a protective plastic material.
- Not suitable for cars with rear spoilers or plastic frames around rear door etc.
- Patented Thule design.

ClipOn 9103, 9104

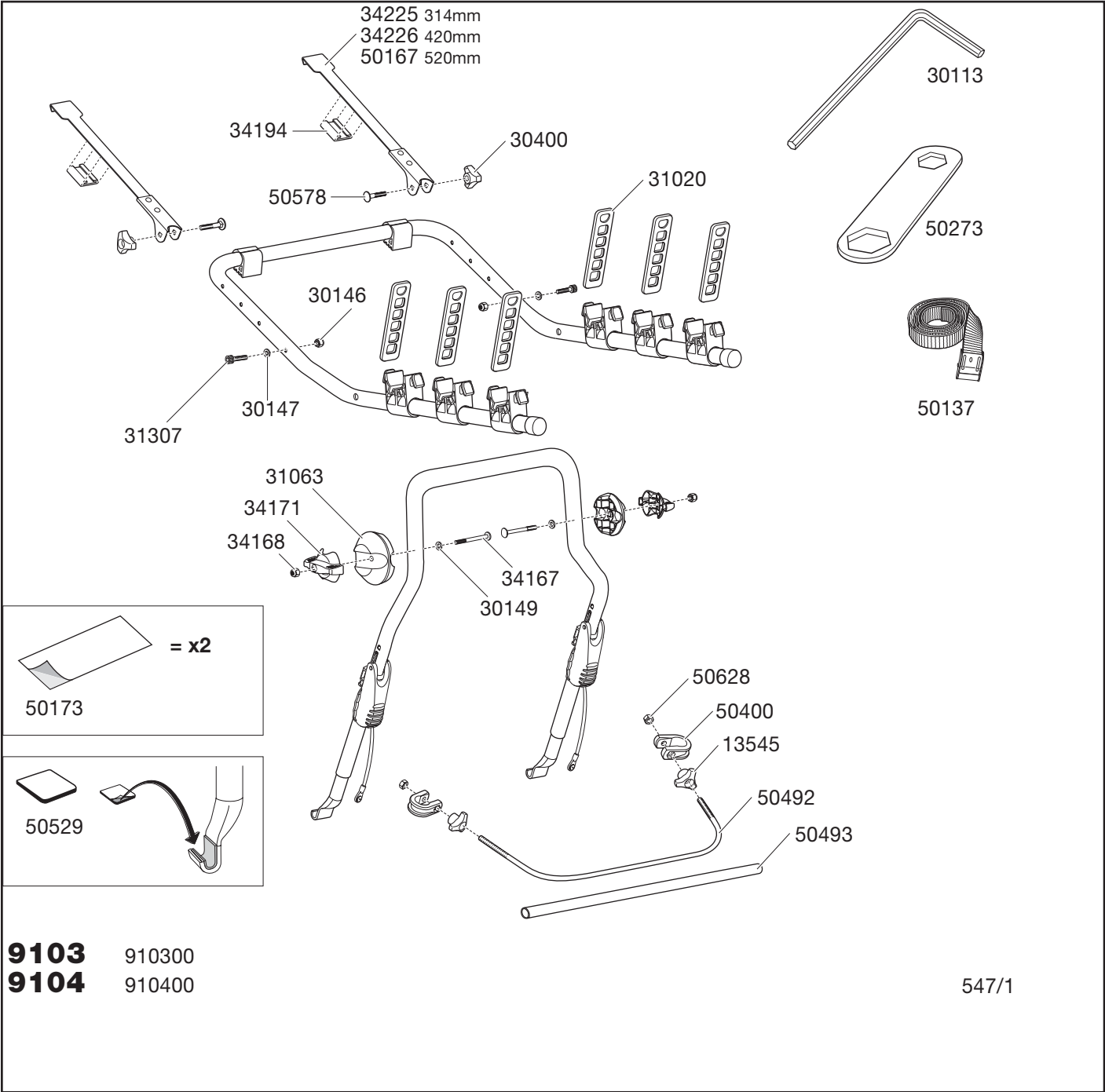

Individual packs

Pallet

Product	EAN	Kg	L/W/H in cm
9103	7313020023670	7,0	91/7/23/54,8
9104	7313020023687	8,5	91/7/23/54,8

Product	Qty/kg	L/W/H in cm
9103	12/99	120/80/120
9104	12/117	120/80/120